

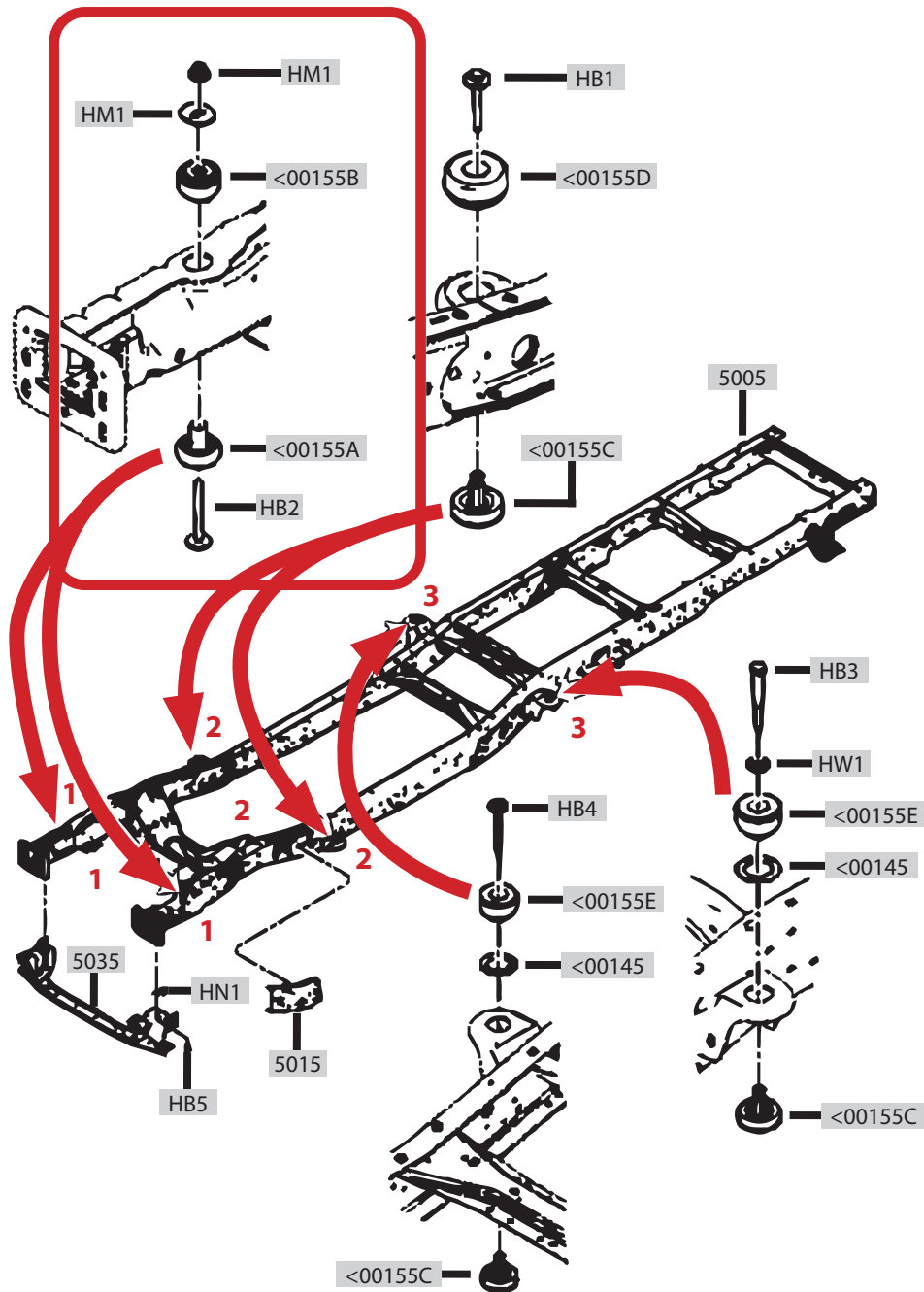

# TECH NOTES: LINE DIAGRAM

**ATTENTION:** Refer to the appropriate shop manual for your vehicle to obtain specific service procedures for this part. If you do not have a service manual or lack the skill to install this part, it is recommended that you seek the services of a qualified technician. Pay special attention to all cautions and warnings included in the shop manual. Read and follow all instructions carefully.

## Ford 2007-1999



Position	Part #
1	924-050/330
2	924-328
3	924-329